

Composite dry sliding bushings, metric dimensions

Principal dimensions			Basic load ratings		Mass	Designation
d	D	B	dynamic C	static C0		
mm			kN		kg	-
<b>160</b>	165	100	1270	3900	0,97	PCM 160165100 E

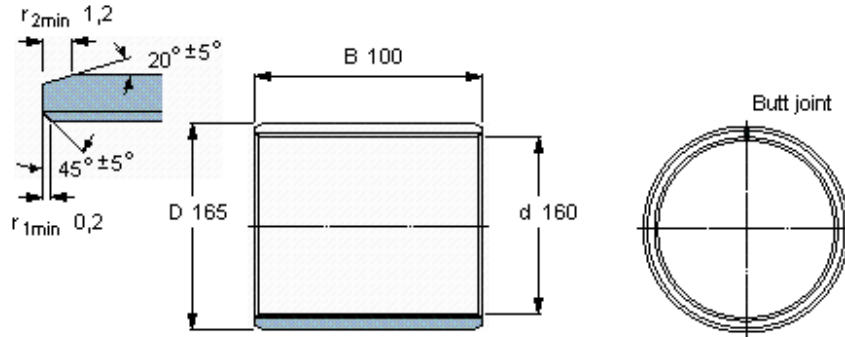

**Specific load factor**  
**Material constant**

K 80  
K<sub>M</sub> 480